

BTS-10 & BTS-6 Bridge Plugs

DIMENSIONAL DATA

Plug Size O.D.	*	A	B	C	D	E	F	G	H	J	K
3.593 BTS-6	L	3.500	3.421	NA	3.437	2.125	4.921	2.955	4.733	12.656	18.281
3.937 BTS-6	L	3.710	3.625	NA	3.648	2.125	4.921	2.955	4.733	12.656	18.281
4.312 BTS-6	L	4.240	4.187	NA	4.187	2.750	4.872	3.890	5.028	13.843	19.468
5.375 BTS-6	L	5.340	5.281	NA	5.260	3.687	5.932	4.915	5.932	16.875	**
5.687 BTS-6	L	5.610	5.562	NA	5.546	3.687	5.932	4.915	5.932	16.875	**
3.593 BTS-10	R	3.500	3.421	3.437	3.437	2.125	4.921	5.470	4.733	15.155	20.780
3.937 BTS-10	R	3.710	3.625	3.648	3.648	2.125	4.921	5.470	4.733	15.155	20.780
4.312 BTS-10	R	4.240	4.187	4.187	4.187	2.750	4.872	5.390	5.028	15.343	17.093
5.375 BTS-10	R	5.340	5.281	5.260	5.260	3.687	5.932	7.250	5.932	19.124	**
5.687 BTS-10	R	5.610	5.562	5.546	5.546	3.687	5.932	7.250	5.932	19.124	**

*- The second column indicates which illustration to use for plug dimensioning (left or right).
 **- The shear stud on this size does not extend above the top of the body.
 Some sizes differ slightly from the illustrations shown

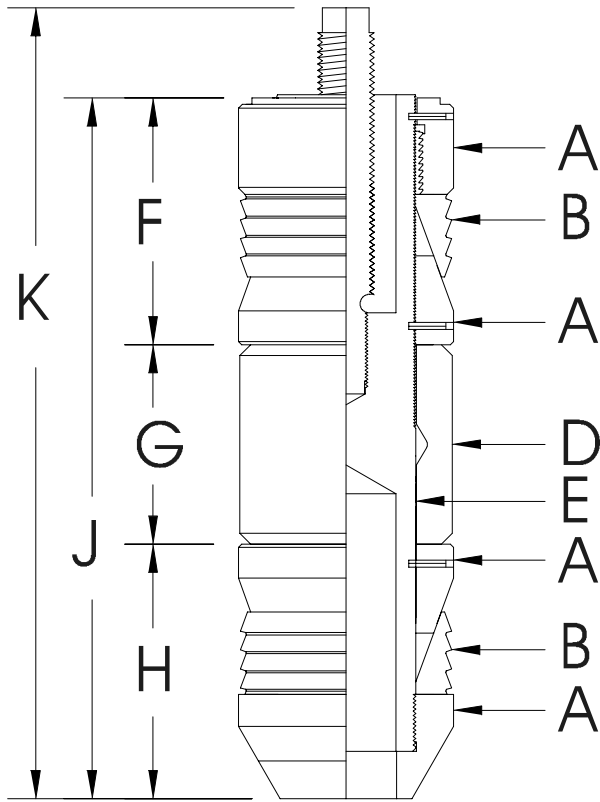

BTS-6 Bridge Plug

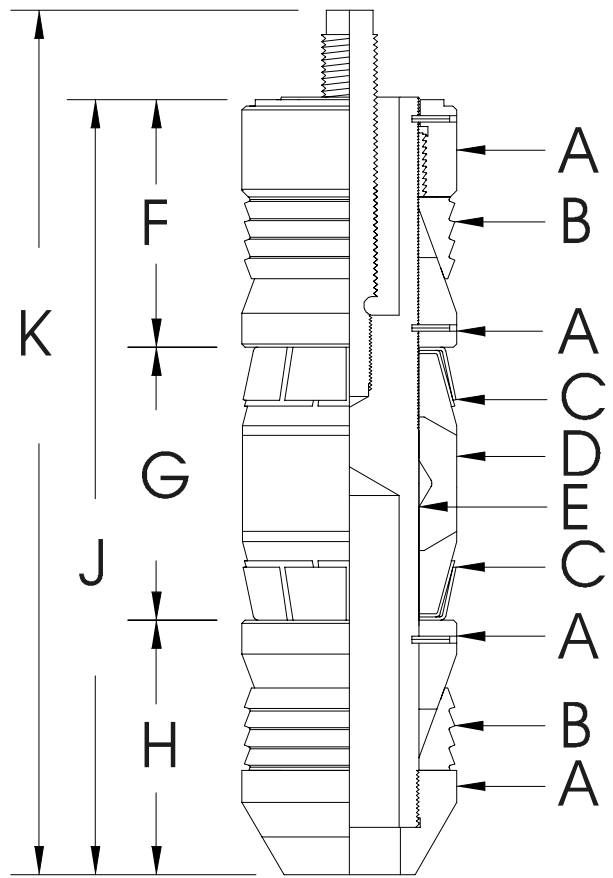

BTS-10 Bridge Plug